

## GRANDRAKE SLIDING

GranFit / Single-deck

Frozen Horizontal, Vertical and Semivertical



BEST ENERGY CLASS\*



## Product Categories



Frozen Food  
and Ice  
cream

## Technical Features



Electric  
defrost



High  
efficiency  
fans



LED lighting

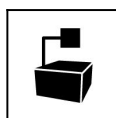

Remote  
condensing  
unit



Ventilated

## GRANDRAKE SLIDING

GranFit / Single-deck

Frozen Horizontal, Vertical and Semivertical

### Certification and Patents



Eurovent

### Product Range

| GRANDRAKE SLIDING   |  |        |         |             |
|---|--|--------|---------|-------------|
| Length-Lunghezza<br>Longueur-Länge-Longitud<br>mm   | 1885   | 2500   | 3750    | EOL<br>2245 |
| <b>GRANDRAKE<br/>SLIDING</b>  | •  | •      | •       | •           |
| Display area Superficie<br>di esposizione<br>Warenpräsentationsfläche<br>Surface d'exposition<br>Superficieexpositiva<br>m2 | 2.45   | 3.25   | 4.87    | 2.79        |
| Loading area<br>Superficie di appoggio<br>Nutzfläche<br>Surface de chargement<br>Superficie de apoyo<br>m2                  | 2.02   | 2.68   | 4.03    | 2.41        |
| Net storage capacity<br>Capacità netta<br>Nutzinhalt<br>volume utile<br>Capacitat neta<br>dm3                               | 708.00   | 939,97 | 1412,22 | 734,3       |
| End thickness<br>Spessore spalla<br>Stärke der Seitenwand<br>Épaisseur de cheue joue<br>Espesor lateral<br>mm               | Spalla panoramica/Panoramic end/Joue<br>panoramique/ Verglaste Seitenwand/ Lateral<br>panorámico: 70.00<br>(+104 batticarrello/bumper rail/pare-chocs/<br>Stoßstange/parachoque) |        |         |             |

# GRANDRAKE SLIDING

GranFit / Single-deck

Frozen Horizontal, Vertical and Semivertical

## Cross Sections

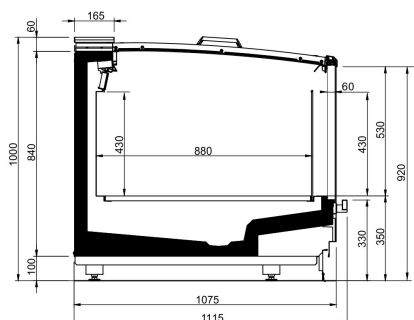

Sezione GranDrake\_Linear\_Sliding Covers

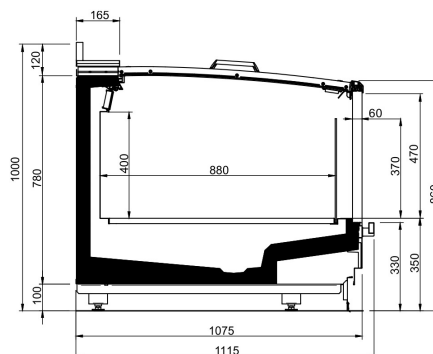

GranDrake Sliding - EOL

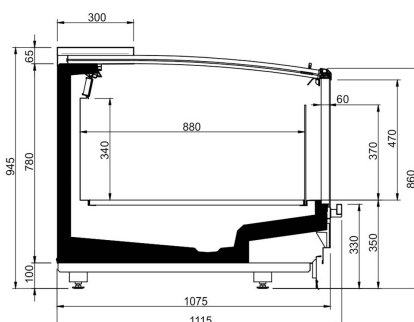

GRANDRAKE ERGO SLIDING COVERS LINEAR

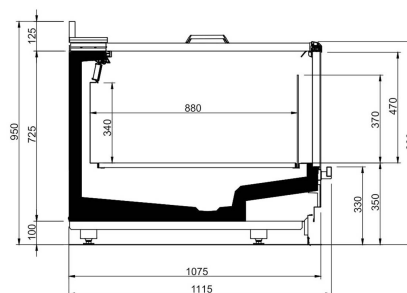

GRANDRAKE ERGO SLIDING COVERS END OF LINE