



## Product categories



Frozen Food  
and Ice cream

## Technical features



Ventilated

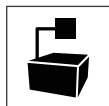

Remote  
condensing unit



LED lighting



High efficiency  
fans



Electric defrost

## Certification and patents



Eurovent\*

\* Epta S.p.A. participates in the ECC programme for:  
Refrigerated display cabinets (RDC); Check ongoing validity  
of certificate online: [www.eurovent-certification.com](http://www.eurovent-certification.com)  
or using: [www.certiflash.com](http://www.certiflash.com)

## Product range

CAYMAN UP						
Length-Lunghezza Longueur-Länge-Longitud mm			1880	2500	3750	EOL2240
CAYMAN UP	H2000	LG300	•	•	•	•
		HG400	•	•	•	•
	H2200	LG300	•	•	•	•
		HG400	•	•	•	•
Display area Superficie di esposizione Warenpräsentationsfläche Surface d'exposition Superficie expositiva m2	H2000	LG300	1.71	2.29	3.44	1.71
		HG400	1.83	2.45	3.68	1.83
	H2200	LG300	1.94	2.60	3.91	1.94
		HG400	2.06	2.76	4.15	2.06
Loading area Superficie di appoggio Nutzfläche Surface de chargement Superficie de apoyo m2	H2000	LG300	2.22	2.94	4.41	2.22
		HG400	2.22	2.94	4.41	2.22
	H2200	LG300	2.22	2.94	4.41	2.22
		HG400	2.22	2.94	4.41	2.22
Net storage capacity Capacità netta Nutzinhalt volume utile Capacitat neta dm3	H2000	LG300	1193.00	1581.00	2372.00	1193.00
		HG400	1193.00	1581.00	2372.00	1193.00
	H2200	LG300	1344.00	1781.00	2672.00	1344.00
		HG400	1344.00	1781.00	2672.00	1344.00
End thickness Spessore spalla Stärke der Seitenwand Épaisseur de cheue joue Espesor lateral mm			51.00 (+ 104 Batticarrello/Bumper Rail/Pare-choc/Wagenstoßleiste/Parachoques)			

## Cross sections

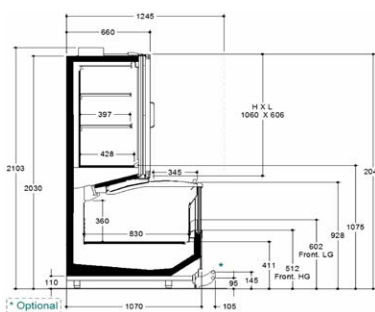

20 LINEAR

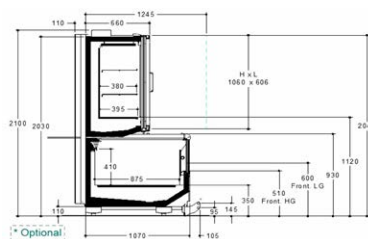

EOL - 20

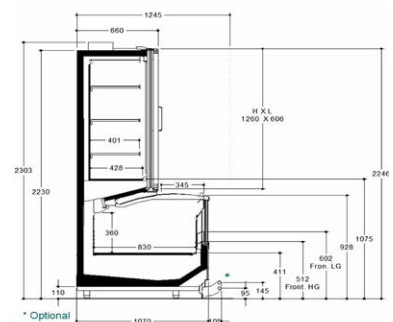

22 LINEAR

## Cross Sections

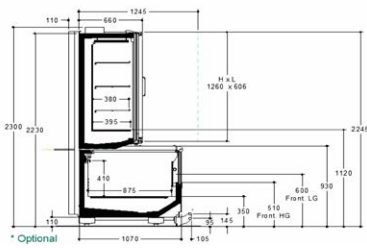

EOL - 22

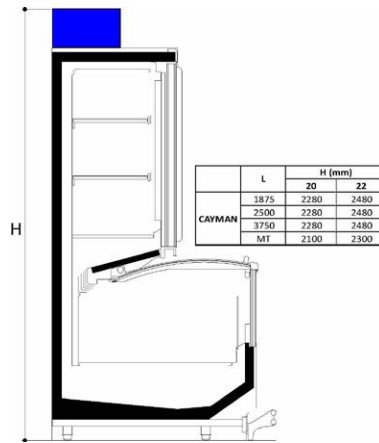

EPTABLUE - OPTION